

**vtech**<sup>®</sup>

Parent's Guide

## Walk & Wiggle Pup



**VTech understands that a child's needs and abilities change as they grow and with that in mind we develop our toys to teach and entertain at just the right level...**

## **vtech** Baby

**Toys that will stimulate their interest in different textures, sounds and colours**

### **I am...**

...responding to colours, sounds and textures

...understanding cause and effect

...learning to touch, reach, grasp, sit-up, crawl and toddle

**Birth-36 months**



## **Pre-School**

**Interactive toys to develop their imagination and encourage language development**

### **I want...**

...to get ready for school by starting to learn the alphabet and counting

...my learning to be as fun, easy and exciting as can be

...to show my creativity with drawing and music so my whole brain develops

**3-6 years**



## **Electronic Learning Computers**

**Cool, aspirational and inspiring computers for curriculum related learning**

### **I need...**

...challenging activities that can keep pace with my growing mind

...intelligent technology that adapts to my level of learning

...National Curriculum based content to support what I'm learning at school

**4-10 years**



To learn more about this and other VTech® products, visit [www.vtech.co.uk](http://www.vtech.co.uk)

# INTRODUCTION

Meet the Walk & Wiggle Pup by **VTech**®! He really is a great companion for your little one. Shake puppy's toy to see his tricks, hear puppy sounds and melodies. Press one of the three shape buttons on the side of the puppy to hear numbers, shapes, fun phrases, songs, melodies and sounds.

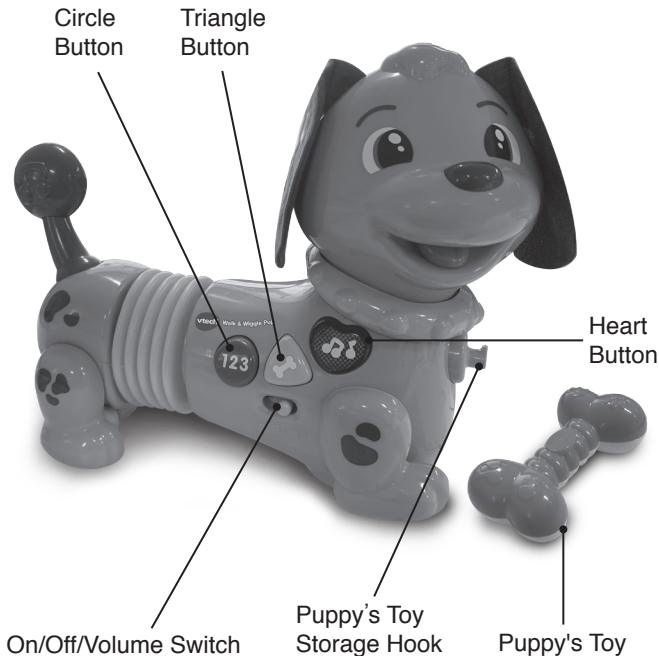

# INCLUDED IN THIS PACKAGE

- One **Walk & Wiggle Pup**
- One Puppy's Toy
- One Parent's Guide

## WARNING:

All packing materials such as tape, plastic sheets, packaging locks, removable tags, cable ties and packaging screws are not part of this toy and should be discarded for your child's safety.

## NOTE:

Please keep this Parent's Guide as it contains important information.

## Unlock the packaging locks:

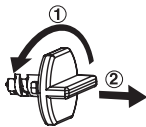

- ① Turn the packaging lock anticlockwise several times.
- ② Pull out and discard the packaging lock.

# GETTING STARTED

## BATTERY REMOVAL AND INSTALLATION

1. Make sure the unit is turned **OFF**.
2. Locate the battery cover on the back of the puppy's head. Use a screwdriver to loosen the screw.
3. If used or spent batteries are present, remove these batteries from the unit by pulling up on one end of each battery.
4. Install 4 new AA (AM-3/LR6) batteries following the diagram inside the battery box. (The use of new alkaline batteries is recommended for maximum performance).
5. Replace the battery cover and tighten the screw to secure.

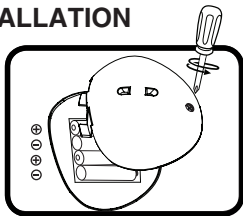

## BATTERY NOTICE

- Use new alkaline batteries or fully charged NI-MH (Nickel Metal-hydride) rechargeable batteries for best performance.
- Use only batteries of the same or equivalent type as recommended.
- Do not mix different types of batteries: alkaline, standard (carbon-zinc) or rechargeable, or new and used batteries.
- Do not use damaged batteries.
- Insert batteries with the correct polarity.
- Do not short-circuit the battery terminals.
- Remove exhausted batteries from the toy.
- Remove batteries during long periods of non-use.
- Do not dispose of batteries in fire.
- Do not charge non-rechargeable batteries.
- Remove rechargeable batteries from the toy before charging (if removable).
- Rechargeable batteries are only to be charged under adult supervision.

## Disposal of batteries and product



The crossed-out wheellie bin symbols on products and batteries, or on their respective packaging, indicates they must not be disposed of in domestic waste as they contain substances that can be damaging to the environment and human health.



The chemical symbols Hg, Cd or Pb, where marked, indicate that the battery contains more than the specified value of mercury (Hg), cadmium (Cd) or lead (Pb) set out in Battery Directive (2006/66/EC).

The solid bar indicates that the product was placed on the market after 13th August, 2005.

Help protect the environment by disposing of your product or batteries responsibly.

For more information, please visit:

[www.recycle-more.co.uk](http://www.recycle-more.co.uk)

[www.recyclenow.com](http://www.recyclenow.com)

# PRODUCT FEATURES

## 1. On/Off/Volume Switch

To turn the unit **On**, slide the **On/Off/Volume Switch** to the **Low Volume** (🔊) or the **High Volume** (🔊🔊) position. You will hear playful phrases and a fun song. To turn the unit **Off**, slide the **On/Off/Volume Switch** to the **Off** (●) position.

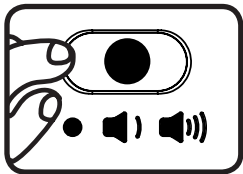

## 2. Automatic Shut Off

To preserve battery life, the **Walk & Wiggle Pup** will automatically power down after approximately two minutes without input. The unit can be turned on again by pressing any button.

**NOTE:** If the unit powers down during play, we suggest changing the batteries.

# ACTIVITIES

## 1. Circle Button

Press the **Circle Button** to learn colours, shapes, numbers and fun puppy facts. The heart will flash with the sounds.



## 2. Triangle Button

Press the **Triangle Button** to learn colours and shapes, and to hear playful phrases that encourage interaction with the puppy. The heart will flash with the sounds.

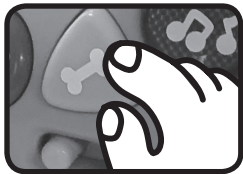

### 3. Heart Button

Press the **Heart Button** to learn colours and shapes, and to hear playful phrases, songs and melodies. The heart will flash with the sounds.

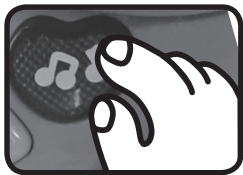

### 4. Puppy's Toy

Shake **Puppy's Toy** to see the puppy walk forward or in a circle. The more you shake the toy, the more the puppy will move. The puppy also responds with cute puppy sounds and playful phrases. If the toy is shaken continuously for about 40 seconds, the puppy will announce that he needs a rest and will not move again for approximately 10 seconds. When not in use, hook the toy to the puppy's collar for easy storage.

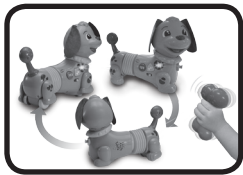

**NOTE:** For best results, shake puppy's toy within four feet of the puppy. The puppy moves best on hard flat surfaces and low pile carpet. For your child's safety, do not place the moving puppy on clothing, skin or hair. Adult supervision is recommended.

# SING-ALONG SONG LYRICS

## Song 1

I love to play with you, you love to play with me.  
Shake my toy and I will run.  
Playing is so much fun.  
I love to woof-woof-woof, when playing with my best friend.

## Song 2 – Long version

I wag my tail when I am having fun,  
I bark when I am happy.  
I run and play and giggle all day,  
Then I get sleepy.

## Song 2 – Short version

I run and play and giggle all day,  
Then I get sleepy.

## Song 3

I have short legs, but I can run.  
I twist and turn and run, run, run!

# MELODY LIST

1. If Your Happy And You Know It
2. Oh Where Has My Little Dog Gone?
3. Animal Fair
4. Did You Ever See a Lassie?
5. Turkey in the Straw
6. One Man Went To Mow a Meadow
7. Old MacDonald
8. For He's a Jolly Good Fellow
9. Hickory, Dickory Dock
10. Humpty Dumpty



11. I've Been Working on the Railroad
12. Mary Had a Little Lamb
13. Raining It's Pouring
14. Bicycle Built for Two
15. Be My Little Baby Bumble Bee

## CARE & MAINTENANCE

1. Keep the unit clean by wiping it with a slightly damp cloth.
2. Keep the unit out of direct sunlight and away from any direct heat sources.
3. Remove the batteries when the unit is not in use for an extended period of time.
4. Do not drop the unit on a hard surface and do not expose the unit to excess moisture.

## TROUBLESHOOTING

If for some reason the program/activity stops working, please follow these steps:

1. Turn the unit **OFF**.
2. Interrupt the power supply by removing the batteries.
3. Let the unit stand for a few minutes, then replace the batteries.
4. Turn the unit back **ON**. The unit will now be ready to play with again.
5. If the unit still does not work, install a brand new set of batteries. If the problem persists, please contact our Consumer Services Department and a service representative will be happy to help you.



**CLASS 1  
LED PRODUCT**

# CONSUMER SERVICES

Creating and developing **VTech®** products is accompanied by a responsibility that we at **VTech®** take very seriously. We make every effort to ensure the accuracy of the information, which forms the value of our products. However, errors sometimes can occur. It is important for you to know that we stand behind our products and encourage you to call our Consumer Services Department with any problems and/or suggestions that you might have. A service representative will be happy to help you.

## **UK Customers:**

Phone: 0330 678 0149 (from UK) or +44 330 678 0149 (outside UK)

Website: [www.vtech.co.uk/support](http://www.vtech.co.uk/support)

## **Australian Customers:**

Phone: 1800 862 155

Website: [support.vtech.com.au](http://support.vtech.com.au)

## **NZ Customers:**

Phone: 0800 400 785

Website: [support.vtech.com.au](http://support.vtech.com.au)

# PRODUCT WARRANTY/ CONSUMER GUARANTEES

## **UK Customers:**

Read our complete warranty policy online at [vtech.co.uk/warranty](http://vtech.co.uk/warranty).

## **Australian Customers:**

VTECH ELECTRONICS (AUSTRALIA) PTY LIMITED –  
CONSUMER GUARANTEES

Under the Australian Consumer Law, a number of consumer guarantees apply to goods and services supplied by VTech Electronics (Australia) Pty Limited. Please refer to [vtech.com.au/consumerguarantees](http://vtech.com.au/consumerguarantees) for further information.

**Visit our website for more  
information about our products,  
downloads, resources and more.**

***www.vtech.co.uk***  
***www.vtech.com.au***

